



BEFORE YOU BEGIN:

It takes two people to safely assemble the wall bed - It is not recommended you try to install this bed on your own. Please read and understand the instructions before you start to assemble. The wall bed **MUST** be securely fasten to the wall. Failure to do so will cause the bed to tip over & may cause damage to the cabinet or serious injury. WallBeds Australia is not responsible for any damages or injuries incurred by incorrect installation.

Whilst these products are DIY it is recommended the wall bed be installed by a qualified tradesperson if you are not comfortable in installing this product.

Instructions Part Reference For Each	Drawer & Cupboard Panels	Sticker Description On Each Panel
M	Drawer Fronts	Floor DRWDoor - Drawer
N	Cupboard Doors	Floor DRW Door - Door
P	Back Panels	Floor DRW Door - Back
U	Top Panels	Floor DRW Door - Top
O	Side Panels	Floor DRW Door - End L/R
Q	Drawer Bottoms	Floor DRW Door - DRW Bot - M
S	Cupboard Bottom Panels	Floor DRW Door - Bottom
R	Drawer Backs	Floor DRW Door - DRW Bck
K	Kick Panels	Floor DRW Door - Kickboard

Alpha WallBed Side Cupboard & Drawer Assembly Instructions

Step 1 – Hardware Assembly

- **Cam Locks** – Insert all Cam Locks into the following panels - **U,S & P**
- **Cam Pins** – Insert all Cam Pins into the following panels - **O**
- **Drawer Runners** – Attach these using the Euro screws to the side panels labelled - **O** -
- **Draw Clips** – Attach these to the drawer front panel – **M** - by tapping them in with a hammer. Ensure that the adjustable screws on the clips are facing the edge of the drawer panel.
- **Door Hinges** – Place the cup part of the hinge into the door panel – **N** - Ensure that the arm of the hinge is facing the edge of the door panel.
- **Door Hinge Blocks** – Attach these to the Side panel – **O** – Ensure the arrow indicator is facing towards the front of the panel.

Step 2 – Drawer Cabinet Assembly

- Attach the Back Panel – **P** -to the Side Panels – **O** – Cam Locks facing towards the back
- Attach the Bottom Panel– **S** – to the Side Panels – **O** – Cam Locks facing down
- Attach the Top Panel – **U** – to the Side Panels – **O**- Cam Locks facing down

Step 3 – Drawer Assembly

- Attach the metal draw sides to the drawer bottom panel – **Q** – using the 4.5mm dome head screws. Once both sides are on then attach the drawer back – **R** – also using the 4.5mm dome head screws.
- Clip the drawer front – **M** – into the metal sides of the draw. Tighten the screws on the side of the draw clips.
- Attach the cupboard door – **N**- by sliding the hinge arms onto the hinge blocks then clip them into place.

Step 4 – Fixing Unit to Alpha Bed

- Once the unit is assembled place it next to the side of the Alpha Bed
- Ensure the front edge of the drawer & cupboard is flush with the front edge of the bed cabinet.
- Place the bookshelf unit on top of the drawer unit and line up the bottom shelf with the front edge of the drawer.
- The bookshelf will then also line up with the front edge of the bed cabinet. Fix the bookshelf to the side of the bed cabinet by using the 28mm wood screws supplied. Use an existing top shelf pin hole for this.
- To attach the drawer/cupboard to the book shelf, simply remove the drawer & screw up into the base of the bookshelf also using the 28mm screws supplied. You may have to pre drill some holes.

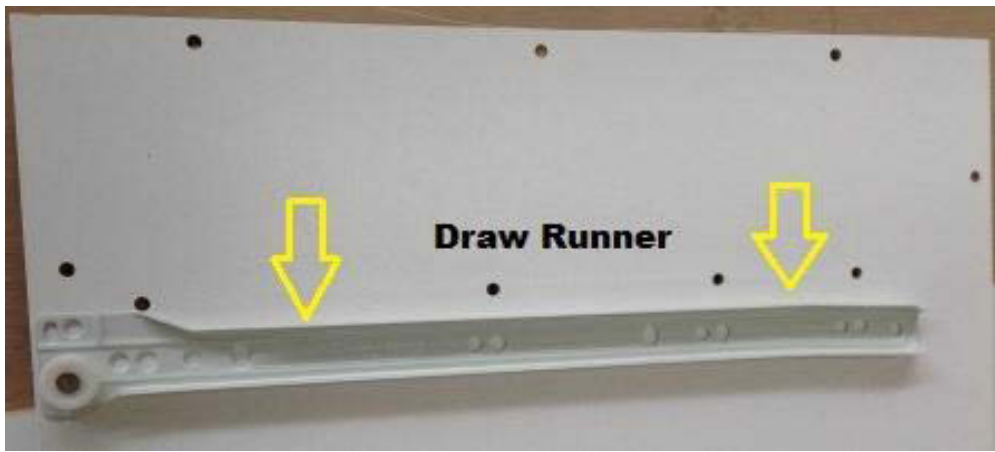

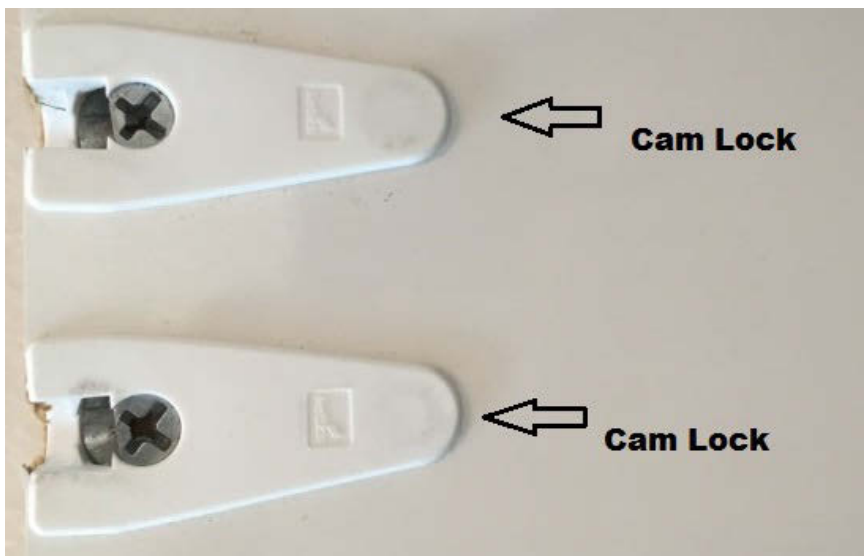
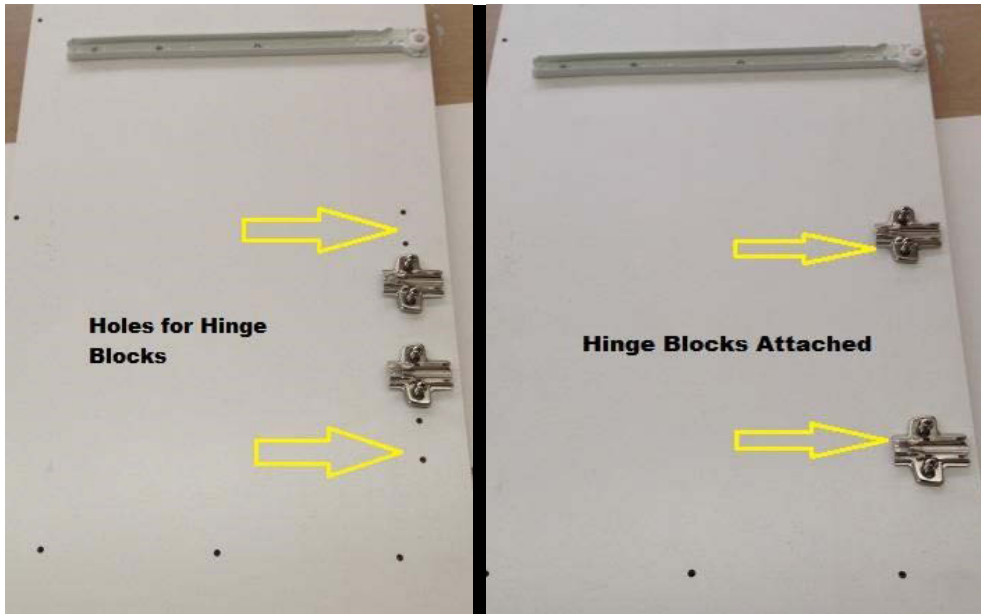



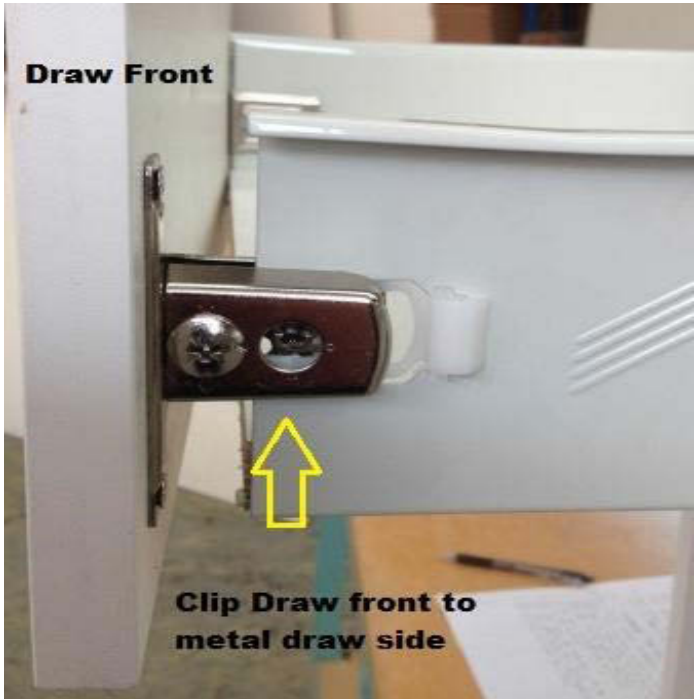

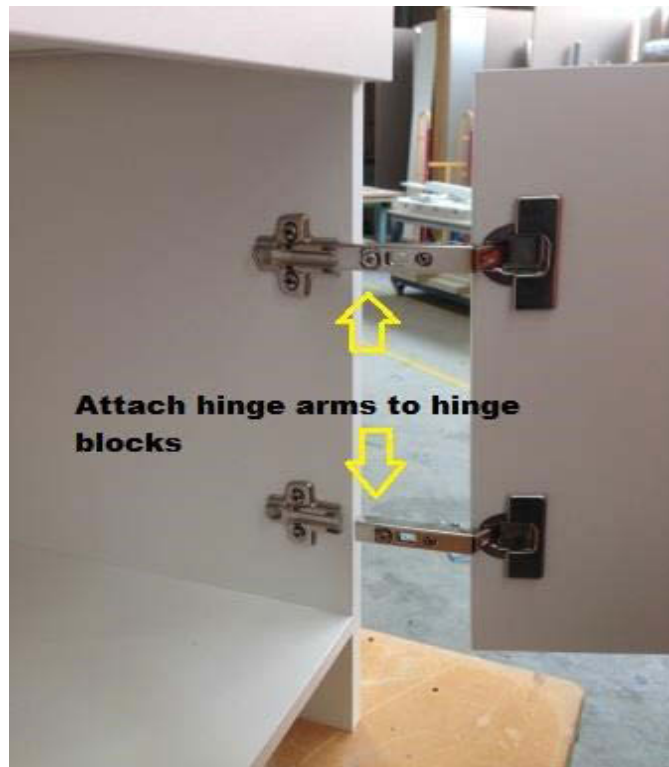

Attach hinge arms to hinge blocks



Clip hinge arms into hinge blocks